

Di-IR900 Photocells with reflector

Feature

- Strong resistance to the sunlight interference, it reaches 100,000Lux.
- Advanced optical technology for long distance detection
- First-class electromagnetic compatibility, strong resistance to the electromagnetic interference
- Short-circuit protection, output protection, and reverse polarity protection for easier wiring

Parameter Description

| | |
|------------------------|--|
| Distance | 10M |
| light source | Red light 660nm |
| Worke Voltage | DC/AC 12-24V |
| Current consumption | ≤40mA |
| IP | IP67 |
| Relay contact capacity | DC 1A 240VAC/30VDC AC 3A 30VDC/250VAC |
| Operating temperature | -25~55°C |
| Power-on delay | 200ms |
| Reaction time | ≤30ms |
| Repeatability | 10% |
| Output indication | Green light for power indicator, red light for output indication |
| Protective function | Short circuit protection, output protection, reverse polarity protection |
| Housing material | PMMA ABS characteristic plastic, lens PMMA |
| Wiring | Standard 2 meter wire output |
| Accessories | 1 * metal bracket, 2 * screw nut |

Wiring diagram

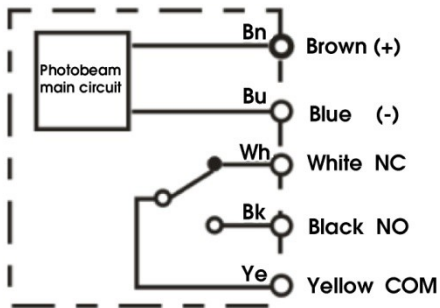

Mechanical dimension drawing (mm)

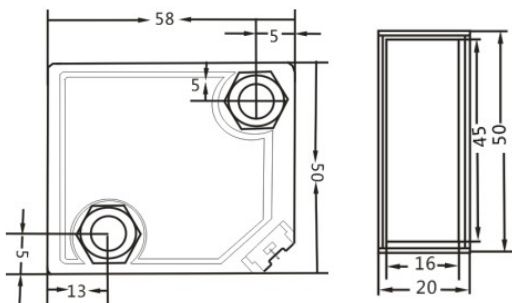

Bracket diagram (mm)

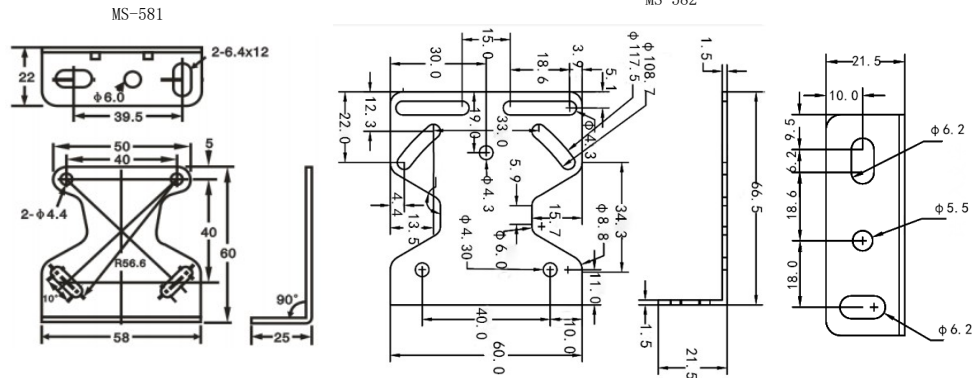

Reflector Chart (mm)

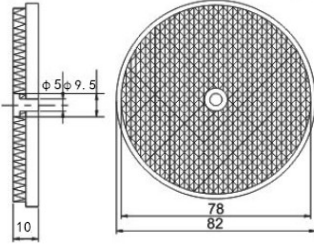

Attention

1. This product cannot be used when the power is turned on (within 200ms);
2. When using the reflector type photoelectric switch, if the object to be detected is a smooth flat glass or mirror, it is necessary to select a photoelectric switch with a polarization function.
3. Be sure to connect properly when connecting the circuit to avoid damage to the product.

Maintenance and repair

In order to make the photoelectric switch work stably for a long time, as with the general controller, please perform the following periodic inspections:

1. Check whether the installation position of the detecting object and the photoelectric switch is offset, loose or deformed;
2. Check wiring, connection parts for looseness, poor contact and disconnection;
3. Check the test surface for any deposits such as sticky metal dust;
4. Check the use temperature and ambient conditions for abnormalities;

Warning: This sensor is not related to safety and is not intended for use as a personal safety device.